

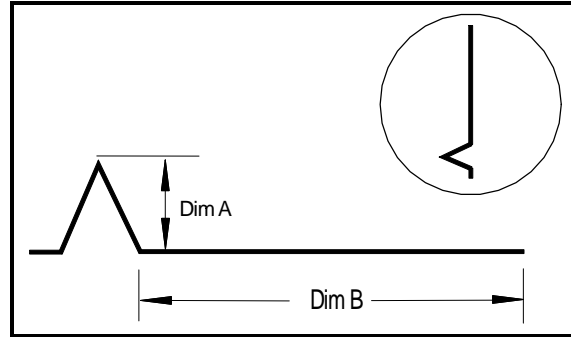

## #7 WEEP SCREEN

**PRODUCT ID: SWS**

Compare to: W-S



**DESCRIPTION:** Industry standard (#7) weep screed, directs moisture away from plaster wall. Available with or without weep holes. When fabricated with .025" aluminum product can be overlapped at installation rather than butting ends.

**MATERIAL /**

**THICKNESS:** .025 Aluminum, 26 GA Galvanized Steel, 26 GA Stainless Steel and 16 oz. Copper

**ASTM:** A653, LFQ, C1063, B209, B69

**LENGTH:** Standard: 10 ft.

**TO ORDER:** DETERMINE THE FOLLOWING:

- Ground Size (Dim A) and Nail Flange (Dim B)
- Type of Material: Galvanized, Stainless, Aluminum, Copper
- Weep Holes or No Holes

**STANDARD SIZES:**

GROUND (DIM. A)	NAIL FLANGE (DIM. B)
3/8"	1"
1/2"	2"
5/8"	3-1/2"
3/4"	4-1/2"
7/8"	5"
1"	5-1/2"

Custom sizes available

**BRAND X METALS, INC.**

1641 So. Sinclair St. ♦ Anaheim, CA 92806 ♦ PH: 714-978-3600 ♦ FAX: 714-978-3601

[www.brandxmetals.com](http://www.brandxmetals.com)