



## WINDOW SURROUNDS

**PRODUCT ID:** WSD – 400

Compare to: FRWDM

**DESCRIPTION:**

Brand X Metals, Inc. offers several plaster termination treatments for window openings. Our Window Header w/ Drip Edge (pt # WSD-400) is part of our *Window Surround System* and provides several benefits to the customary method of running 3-coat plaster in the return for recessed windows.

Our WS Series allows flexible positioning of the window frame which eliminates additional lath and plaster materials as well as labor costs for the recessed return and creates a smooth metal to metal caulk joint which results in the best possible condition for preventing leaks.

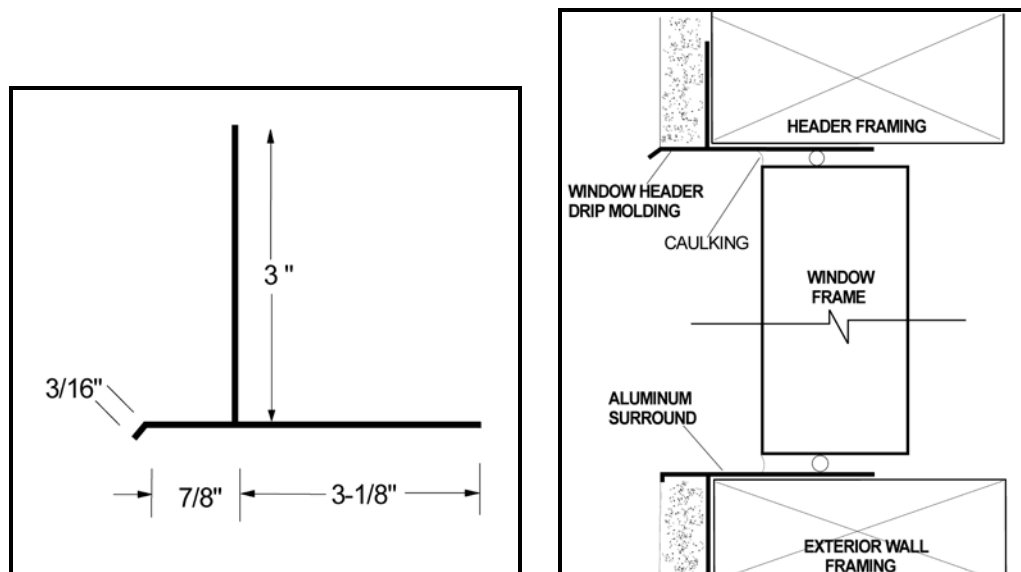

**MATERIAL:** Aluminum Alloy 6063 T5 **ASTM:** B 221  
**THICKNESS:** Nominal .050  
**LENGTH:** Standard: 10 ft.  
**FINISH:** Standard - Clear Anodized (Architectural 200R1 med. Etch AAM32C10A21)  
Also available:

- Alodine® or Chem-Film a.k.a. 'chemical conversion'
- Custom anodized finishes
- Kynar® fluoro-polymer extrusion coating

**BRAND X METALS, INC.**

1641 So. Sinclair St. ♦ Anaheim, CA 92806 ♦ PH: 714-978-3600 ♦ FAX: 714-978-3601

[www.brandxmetals.com](http://www.brandxmetals.com)