



## WIDE 'V' REVEAL

**PRODUCT ID: PCV 75-150**

Compare to: PCSV-75

**DESCRIPTION:** The Brand X Metals 'V' Reveal replicate the appearance of pre-cast concrete tilt-up panel joints. The 'V' channel reveals give the architect the ability to maintain the appearance of pre-cast panels in adjacent construction or store front build outs.

**MATERIAL:** Aluminum Alloy 6063 T5 **ASTM:** B 221

**THICKNESS:** Nominal .050

**LENGTH:** Standard: 10 ft.

**FINISH:** Standard - Clear Anodized (Architectural 200R1 med. Etch AAM32C10A21)

Also available:

- Alodine® or Chem-Film a.k.a. 'chemical conversion'
- Custom anodized finishes
- Kynar ® fluoro-polymer extrusion coating

**OPTIONS:** **Intersections** – Mitered / Welded intersections can be fabricated in 3 and 4 way configurations as well as inside and outside corners

**Radius** – Channel screeds can be curved to meet your job's specifications

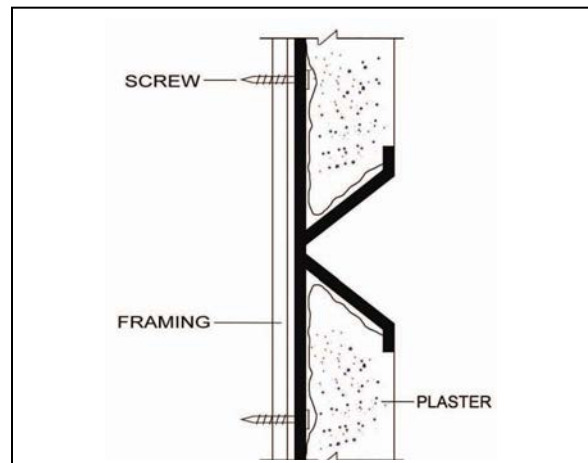
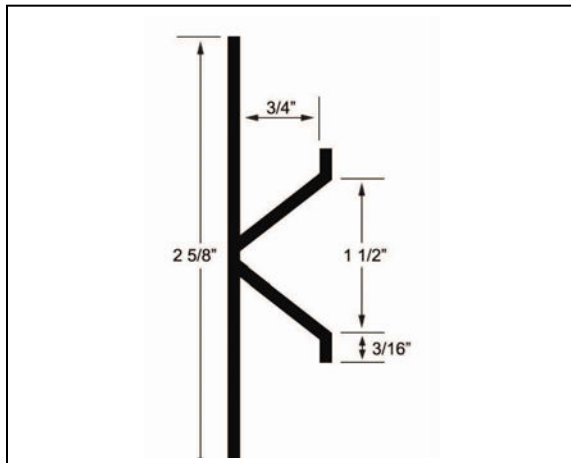

**BRAND X METALS, INC.**

1641 S. Sinclair St. ♦ Anaheim, CA 92806 ♦ PH: 714-978-3600 ♦ FAX: 714-978-3601

[www.brandxmetals.com](http://www.brandxmetals.com)